



Main Features:-

- ◆ Connection system for solvent weld, threaded and flanged
- ◆ High flow coefficient and minimum pressure drop
- ◆ Internal metal parts totally isolated from conveyed fluid
- ◆ Innovative Circular Diaphragm Sealing Angle system
- ◆ Easy to clean valve interior



Suitable Applications & Approvals:



VM DN15/100 uPVC

EU MANUFACTURER:

The VM is particularly suitable for shutting off and regulating abrasive or dirty fluids. The handwheel control and diaphragm seal provide precise and effective control, while reducing the risk of water hammer to a minimum.

TECHNICAL SPECIFICATIONS

Construction	Single wear diaphragm valve
Size Range	DN 15 ÷ 100
Nominal Pressure	PN 10 with water at 20 °C
Operating Temperature	0 °C ÷ 60 °C
Coupling Standards	Solvent welding: EN ISO 1452, EN ISO 15493, BS 4346-1, DIN 8063, NF T54-028, ASTM D 2467, JIS K 6743. Can be coupled to pipes according to EN ISO 1452, EN ISO15493, DIN 8062, NF T54-016, ASTM D 1785, JIS K 6741 Thread: ISO 228-1, DIN 2999, ASTM D 2464, JIS B 0203 Flanging system: ISO 7005-1, EN ISO 1452, EN ISO 15493, EN 558-1, DIN 2501, ANSI B16.5 Cl.150, JIS B2220
Reference Standards	Construction criteria: EN ISO 16138, EN ISO 1452, EN ISO 15493 Test methods and requirements: ISO 9393 Installation criteria: DVS 2204, DVS 2221, UNI 11242
Valve Material	Body: PVC-U Bonnet and handwheel: PP-GR
Diaphragm material	EPDM, FPM, PTFE (on request NBR)
Control options	Manual control; pneumatic actuator

This product is compatible for mounting with standard pneumatic or electric actuators that use standard ISO5211 profiles (F05, F07, F10), when combined with the optional actuation kit accessory. Allvalves can supply this product preassembled with a suitable actuator on request.



T +44 (0)1386 552369

E sales@allvalves.co.uk

W www.allvalves.co.uk

F +44 (0)1386 554227

Part	Component	Material
1	Handwheel	PP-GR
2	Bonnet	PP-GR
3	Anti-friction disk	POM
4	Lock nut	Brass
5	Indicator - stem	Stainless Steel
6	Shutter	PBT
7	Pin	Stainless Steel
8	Diaphragm	EPDM, FPM, PTFE
9	Body	PVC-U
10	Washer	Zinc plated steel
11	Hexagonal screw	Zinc plated steel
12	Protection plug	PE

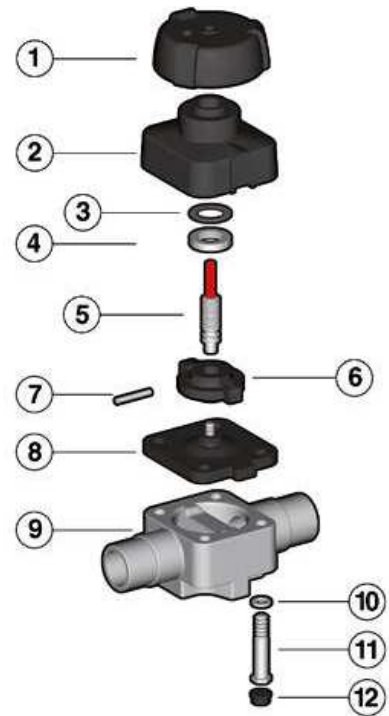

Handwheel in (PP-GR) with high mechanical strength and ergonomic grip for optimum manageability

Optical position indicator supplied as standard

Full protection bonnet in PP-GR, no protruding bolts, no areas where impurities can accumulate. Internal circular and symmetrical diaphragm sealing area

Diaphragm available in EPDM, FPM, PTFE (NBR on request) and easy to replace

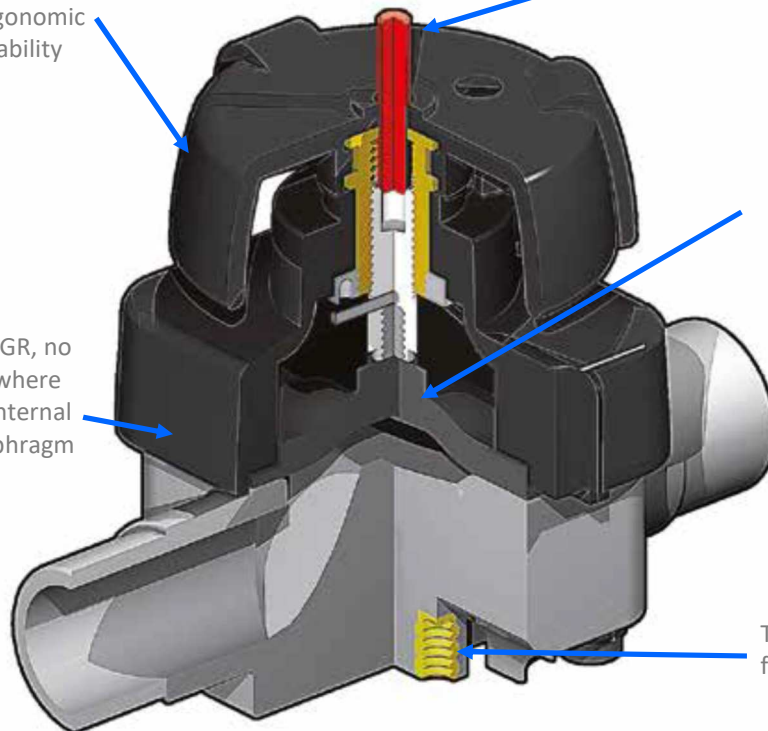

Threaded metal inserts for anchoring the valve



PRESSURE v TEMP

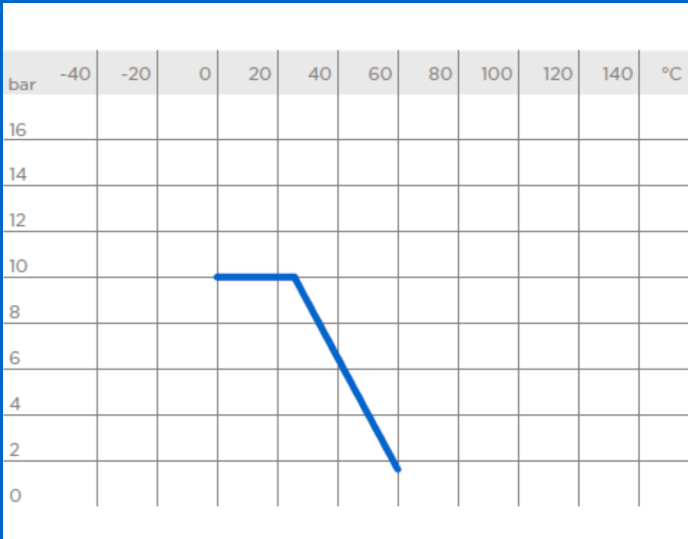

PRESSURE DROP

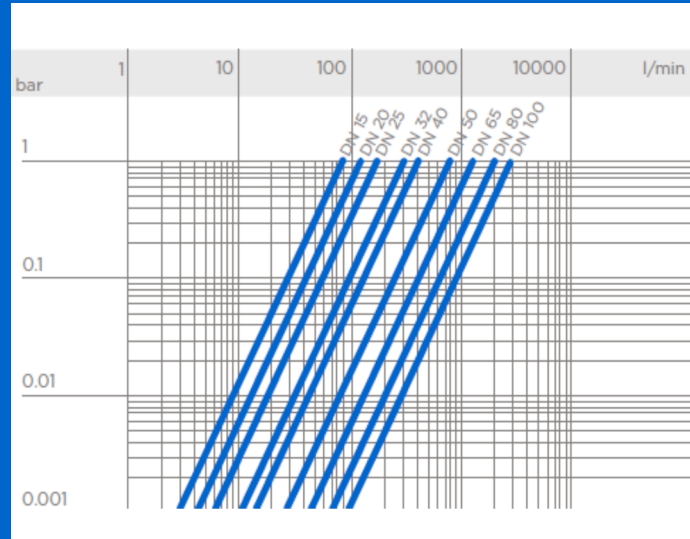

FLOW

DN	15	20	25	32	40	50	65	80	100
Kv100 l/min	93	136	175	300	416	766	1300	2000	2700

The Kv100 flow coefficient is the Q flow rate of litres per minute of water at a temperature of 20°C that will generate $\Delta p=1$ bar pressure drop at a certain valve position.

*The Kv100 values shown in the table are calculated with the valve completely open.

PRODUCT DIMENSIONS

VMDV Diaphragm valve with male ends for solvent welding, metric series

d	DN	PN	B	B ₁	H	h	H	I	J	L	g
20	15	10	95	26	124	12	90	25	M6	16	700
25	20	10	95	26	144	12	90	25	M6	19	700
32	25	10	95	26	154	12	90	25	M6	22	700
40	32	10	126	40	174	18	115	44.5	M8	26	1500
50	40	10	126	40	194	18	115	44.5	M8	31	1500
63	50	10	148	40	224	18	140	44.5	M8	38	2400
75	65	*10	225	55	284	23	200	100	M12	44	7000
90	80	*10	225	55	300	23	200	100	M12	51	7000
110	100	*10	295	69	340	23	250	120	M12	61	10500

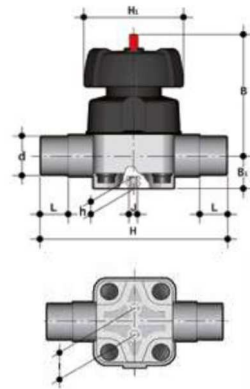

*PTFE PN6

VMUIV Diaphragm valve with female union ends for solvent welding, metric series

d	DN	PN	B	B ₁	E	H	h	H	I	J	L _A	R	Z	g
20	15	10	95	26	41	90	12	90	25	M6	108	1"	115	830
25	20	10	95	26	50	90	12	90	25	M6	108	1¼"	116	860
32	25	10	95	26	58	90	12	90	25	M6	116	1½"	124	895
40	32	10	126	40	72	115	16	115	44.5	M8	134	2"	140	1650
50	40	10	126	40	79	115	16	115	44.5	M8	154	2¼"	16	1730
63	50	10	148	40	98	140	16	140	44.5	M8	184	2¾"	190	2800

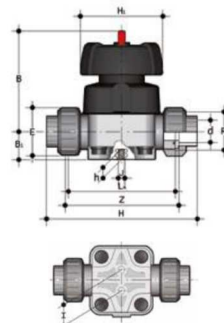

T +44 (0)1386 552369

E sales@allvalves.co.uk

W www.allvalves.co.uk

F +44 (0)1386 554227

VMUFV Diaphragm valve with BSP threaded female union ends

R	DN	PN	B	B ₁	E	H	h	H ₁	I	J	L _A	R ₁	Z	g
½"	15	10	95	26	41	148	12	90	25	M6	108	1"	118	830
¾"	20	10	95	26	50	151	12	90	25	M6	108	1¼"	118	860
1"	25	10	95	26	58	165	12	90	25	M6	116	1½"	127	895
1¼"	32	10	126	40	72	188	16	155	44.5	M8	134	2"	145	1650
1½"	40	10	126	40	79	208	16	155	44.54	M8	154	2¼"	165	1730
2"	50	10	148	40	98	246	16	140	44.54	M8	184	2¾"	195	2800

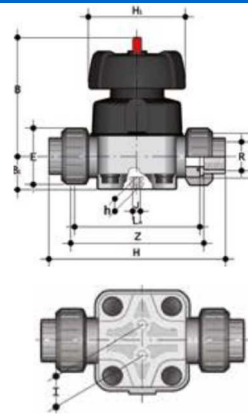

VMUAV Diaphragm valve with female union ends for solvent welding, ASTM series

R	DN	PN	B	B ₁	E	H	h	H ₁	I	J	L _A	R ₁	Z	g
½"	15	10	95	26	41	16	12	90	25	M6	108	1"	115	830
¾"	20	10	95	26	50	167	12	90	25	M6	108	1¼"	115	860
1"	25	10	95	26	58	180	12	90	25	M6	116	1½"	122	895
1¼"	32	10	126	40	72	208	16	115	44.5	M8	134	2"	144	1650
1½"	40	10	126	40	79	234	16	115	44.5	M8	154	2¼"	164	1730
2"	50	10	148	40	98	272	16	140	44.5	M8	184	2¾"	195	2800

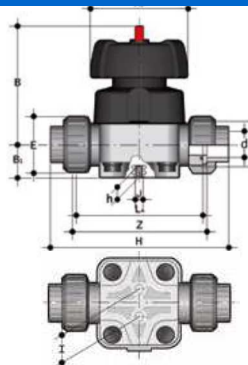

VMULV Diaphragm valve with female union ends for solvent welding, BS series

R	DN	PN	B	B ₁	E	H	h	H ₁	I	J	L _A	R ₁	Z	g
½"	15	10	95	26	41	147	12	90	25	M6	108	1"	114	830
¾"	20	10	95	26	50	154	12	90	25	M6	108	1¼"	116	860
1"	25	10	95	26	58	166	12	90	25	M6	116	1½"	121	895
1¼"	32	10	126	40	72	184	16	115	44.5	M8	134	2"	142	1650
1½"	40	10	126	40	79	222	16	115	44.5	M8	154	2¼"	162	1730
2"	50	10	148	40	98	266	16	140	44.5	M8	184	2¾"	194	2800

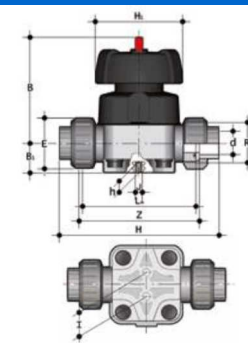

VMOV Diaphragm valve with fixed flanges, drilled PNI0/16. Face to face according to EN 558-1

R	DN	PN	B	B ₁	F	f	H	H ₁	I	J	S _p	U	g
20	15	10	95	26	65	14	130	90	25	M6	11	4	840
25	20	10	95	26	75	14	150	90	25	M6	135	4	900
32	25	10	95	26	85	14	160	90	25	M6	14	4	990
40	32	10	126	40	100	18	180	115	44.5	M8	14	4	1960
50	40	10	126	40	110	18	200	115	44.5	M8	16	4	2075
63	50	10	148	40	125	18	230	140	44.5	M8	16	4	3170
75	65	*10	225	55	145	18	290	200	100	M12	21	4	8100
90	80	*10	225	55	160	18	310	200	100	M12	21.5	8	8500
110	100	*10	295	69	180	18	350	250	120	M12	22.5	8	12400

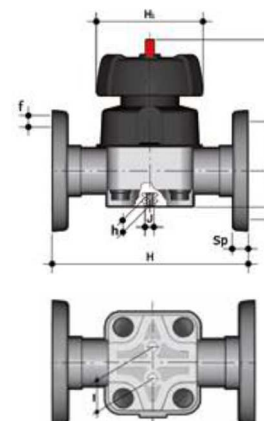

VMOAV Diaphragm valve with fixed flanges, drilled ANSI B16.5 cl. 150 #FF

R	DN	PN	B	B ₁	F	f	H	H ₁	I	J	Ş _p	U	g
½"	10	95	95	26	60.3	15.9	130	90	25	M6	11	4	840
¾"	10	95	95	26	69.9	15.9	150	90	25	M6	13.5	4	900
1"	10	95	95	26	79.4	15.9	160	90	25	M6	14	4	990
1¼"	10	126	126	40	88.9	15.9	180	115	44.5	M8	14	4	1960
1½"	10	126	126	40	98.4	15.9	200	115	44.5	M8	16	4	2075
2"	10	148	148	40	120.7	19.1	230	140	44.5	M8	16	4	3170
2½"	*10	225	225	55	139.7	19.1	290	200	100	M12	21	4	8100
3"	*10	225	225	55	152.4	19.1	310	200	100	M12	21.5	4	8500
4"	*10	295	295	69	190.5	19.1	350	120	120	M12	22.5	8	12400

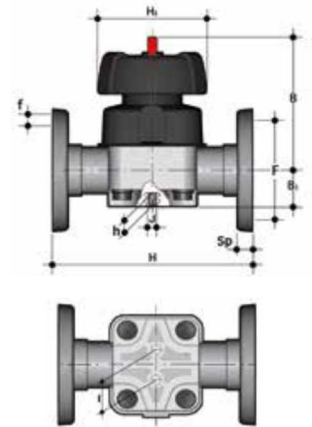

Q/BBE-L End connectors IN PE100, long spigot, for joints with electrofusion fittings or for butt welding

d	DN	PN	L	H	SDR
20	15	16	95	298	11
25	20	16	95	298	11
32	25	16	95	314	11
40	32	16	95	330	11
50	40	16	95	350	11
63	50	16	95	380	11

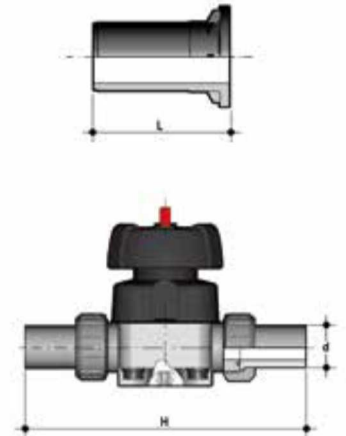

PRODUCT FEATURES



- 1 Handwheel** in (PA-GR) with high mechanical strength and ergonomic **grip for optimum manageability**
- 2 Metal optical position indicator** supplied as standard
- 3 Full protection bonnet** in PP-GR. Internal circular and symmetrical diaphragm sealing area
- 4 Diaphragm** available in EPDM, FPM, PTFE (NBR on request) and easy to replace
- 5 Threaded metal inserts** for anchoring the valve
- 6 New valve body internal design:** substantially higher flow coefficient resulting in lower pressure drops. Optimised adjustment curve for effective and precise flow rate regulation

T +44 (0)1386 552369

E sales@allvalves.co.uk

W www.allvalves.co.uk

F +44 (0)1386 554227